

Full-Electric Bed

User Manual & Entrapment Guide

For use with item#
PBFEB3M
PBFEB3MLO



This manual should be read in its entirety by bed users, care givers and maintenance personnel prior to assembly or use.

TABLE OF CONTENTS

User Manual	3 — 21
Warnings	3 – 5
Special Notes	5
Bed Components	6
Bed Parts Diagram	7
Assembly Instructions	8 – 17
Operation	18-19
Head/Footboard Opt. Height Adjustments	20
Maintenance/Safety	20
Specifications	21
Warranty	21

WARNINGS.

PLEASE READ ALL WARNINGS/CAUTIONS BEFORE USE

- **TO ENSURE YOUR SAFETY IN USING THIS HOME CARE BED, ALL WARNINGS AND SAFETY INFORMATION AND ALL INSTRUCTIONS MUST BE FOLLOWED. FAILURE TO DO SO MAY RESULT IN SERIOUS BODILY INJURY OR DAMAGE TO THE BED. DO NOT USE THIS PRODUCT WITHOUT FIRST READING AND UNDERSTANDING THE INSTRUCTIONS CONTAINED IN THIS BOOKLET. IF YOU ARE UNABLE TO UNDERSTAND THE WARNINGS, CAUTIONS OR INSTRUCTIONS, CONTACT A HEALTHCARE PROFESSIONAL, DURABLE MEDICAL DEALER OR TECHNICAL PERSONNEL.**
- Users who are unable to understand or follow these instructions and warnings or who have limited physical capabilities should be supervised or assisted while using the bed.
- **DO NOT** use in oxygen-enriched environments or near flammable or explosive gases.
- Possible fire hazard when used with oxygen administering equipment other than nasal or masked type.
- When using nasal or masked type administering equipment, oxygen or air tubing **MUST** be routed and secured properly to ensure that tubing does **NOT** become entangled and eventually severed during normal operation of this Electric bed.
- Liquids can cause electrical hazards. If a spill occurs, **UNPLUG** the bed immediately. Clean up spill and allow bed or area to dry thoroughly before plugging in the bed or using the electric controls again.
- This bed is designed for adults only. **DO NOT** use with or for children. Children must be closely supervised at all times when near the bed.
- **NEVER PERMIT ANY ONE UNDER THE BED AT ANYTIME.**
- When operating or moving the bed, **ALWAYS** ensure that the

individual utilizing the bed is positioned properly within the confines of the bed.

- **ALWAYS** keep clear of moving parts when adjusting the bed. Patient should be centered on the bed with extremities within the mattress area. **DO NOT** allow extremities to extend beyond the sides or between bed rails.
- **DO NOT** use this bed for patient transport. **DO NOT** move the bed while occupied, otherwise injury or damage may result.
- The maximum safe working load of this bed (patient, mattress, bedding, and accessories) is 450lbs/204kg. The maximum user weight is 350lbs/158kg. **ALWAYS** observe the weight limits.
- **DO NOT** stand or climb on bed.
- Bed is intended for a single occupant. **NEVER** allow more than one person to sit or lay on bed at the same time.
- To prevent patient injury due to falls, **ALWAYS** leave bed at lowest height when the patient is unattended.
- Inappropriate handling of the power cord can create an electrical hazard. Regularly inspect cord and plug for damage such as kinking or fraying; **DO NOT** use if cord or plug is damaged, contact your dealer for repair or replacement.
DO NOT unplug by pulling on the cord, this may damage the plug connection. **NEVER** pull, jerk, twist, or severely bend the cord, especially near the plug connection.
DO NOT use this product with power strips or extension cords. **DO NOT** overload wall outlets. **ALWAYS** connect this product to an appropriate voltage outlet; **DO NOT** use with a DC to AC converter.
- **ALWAYS** take care when routing power cords for accessories or other equipment through the space under the bed. Cords should be secured such that they cannot become pinched or damaged by moving parts of

WARNINGS.

the bed. Damaged cords should **NOT** be used.

- It is the responsibility of the patient's physician and caregiver to assess the patient and determine which devices and accessories are needed to support and protect the patient, while limiting risk to the patient. Use of fall protection, pressure management, and transfer assistance mechanisms should be considered as appropriate.
- **DANGER!** Entrapment may cause patient injury or death.
- **DO NOT** use this bed with incompatible mattresses or bed rails. Refer to page 21 of this manual or contact your Compass Health dealer for assistance with purchasing compatible models.
- After bed assembly or maintenance, test to ensure all sections are securely in place and all electrical components operate as intended **BEFORE** use.
- **ALWAYS** lock casters to prevent the bed from moving while occupied. Even with casters locked, some floor surfaces may allow the bed to move slightly; use of the bed on such floor surfaces must be evaluated by the care provider.
- **ALWAYS** use caster locks except when moving the bed.
- When transferring into or out of the bed, **ALWAYS** use lock the locking caster(s). Inspect for correct locking action on caster locks before using bed.
- **DO NOT** attempt to operate the bed controls if the bed is not fully assembled, as this may cause damage to the bed components.
- After the bed has been fully assembled, **ALWAYS** test to make sure that all sections of the bed are properly and securely in place before using.
- Body weight should be evenly distributed over the surface of the bed. **DO NOT** lay, sit or lean in such a way that your entire body weight is placed only on raised head or foot sections of the bed. This includes when assisting the user in repositioning or transferring in or out of bed.

- **DO NOT** use outdoors.
- If the unit is not working properly, discontinue use and call a qualified technician to examine the unit and repair it.
- Keep all moving parts, including the main bed frame, mattress deck (head and foot springs/sections) and all drive shafts free of obstruction (i.e. blankets/sheets, heating blankets/pads, tubing, wiring, etc. and other types of products using electric cords which may get tangled around the bed, side rails or legs) during operation of the bed.
- Keep the product a minimum of 12" away from any direct heat source. Make sure head and foot springs/sections are connected securely to the bed ends before use.
- **DO NOT** use the bed to transport a person in or on the bed. Otherwise, injury or damage may result.
- It is recommended that a qualified technician conduct the initial set up the bed.
- A safety feature of this bed model includes protection against overheating caused by excessive or extended periods of operation. Depending on the duration, this will include multiple/repeated adjustments or the use of multiple functions at the same time. To ensure trouble-free operation, **ALWAYS** allow a slight pause between multiple adjustments and **AVOID** pressing multiple function buttons at a time. If thermal protection is activated, the bed will not respond to pendant commands. To resolve this, release the pendant button and let the bed sit for several minutes. This will reset the protection function time to and restore bed function. Depending on the degree of the overheating, this may take up to 30 minutes.
- **ALWAYS** remove manual crank(s) before performing electronic functions or using the bed. If not removed, the crank(s) will turn when the motor is on and this could cause personal injury or damage to the bed. **ALWAYS** unplug the bed from the electrical outlet before cleaning.
- **DO NOT** open assemblies such as the motors, pendant, junction boxes

warnings continued on next page



WARNINGS.

- or gear boxes. There are no user serviceable parts. Only qualified technicians are permitted to repair these parts. If unqualified individuals perform any work on these beds, the warranty is void.
- After use, some permanent deformation of the bed under load may occur. This is normal and expected unless it affects the function of the bed. Slight sagging or bending at the center of the bed after use does not indicate a safety risk/defect.
 - **DO NOT** place pendant under or between objects. This may cause the unintentional activation of the bed features and may cause injury or damage.
 - If a button on the pendant does not release or sticks, the bed spring will not stop moving. Inspect the covering of the bed's control panel and the patient control panel to assure that the covering is not cracked or damaged.
 - **ALWAYS** keep all electrical cords away from heated or hot surfaces.
 - Refer all servicing to qualified personnel **ONLY**. Grounding reliability depends upon a properly grounded wall outlet. **ALWAYS** unplug the bed from the outlet before servicing or performing any maintenance on the electric bed.
 - **DO NOT** unplug the power cord from the junction box. Damage to cord will result.
 - Use caution when disconnecting the pendant, **DO NOT** press pendant buttons.
 - When bed is not to be used for an extended period, unplug electric bed from the wall outlet.

SAVE THESE INSTRUCTIONS

SPECIAL NOTES

NOTICE:

- The information contained in this document is subject to change without notice.
- **WARNINGS/CAUTION** notices used in this manual apply to hazards or unsafe practices which could result in personal injury and/or property damage.
- Check all parts for shipping damage and test before using. In case of damage, do **NOT** use.
- Contact the dealer for further instruction.
- Your Electric bed has been engineered to provide you with reliable operation.
- The bed has been thoroughly tested and inspected prior to shipment.

INDICATIONS & CONTRAINDICATIONS FOR USE

- This bed is intended for use in Homecare settings, for use with adults (persons weighing at least 88 lbs/40kg, at least 57 in/146cm tall, with a BMI of at least 17).
- This bed is **NOT** intended for use in a hospital or long-term care facilities. This bed is **NOT** intended for use with children.
- This bed is **NOT** intended for patient transport – the bed should **NOT** be moved while occupied.
- This bed is intended for use in Application Environment 4, as defined in IEC 60601-52-2-2015

BED COMPONENTS

Box 1

- 1 Head Board
- 1 Head Spring section
- 4 Casters (2-locking, 2-non-locking)
- 1 Manual
- 1 Wrench
- 1 Emergency Crank

Box 2

- 1 Foot Spring section: Full and Semi-Electric Models include motors, a junction box and Electrical cord already attached.
- 1 Hand Pendant Control and Cord:
- 1 Foot Board
- 1 Drive Shaft: length adjusts to adapt to Full Electric and Semi Electrics models
- 1 Emergency Battery Backup Box (9V batteries not included)

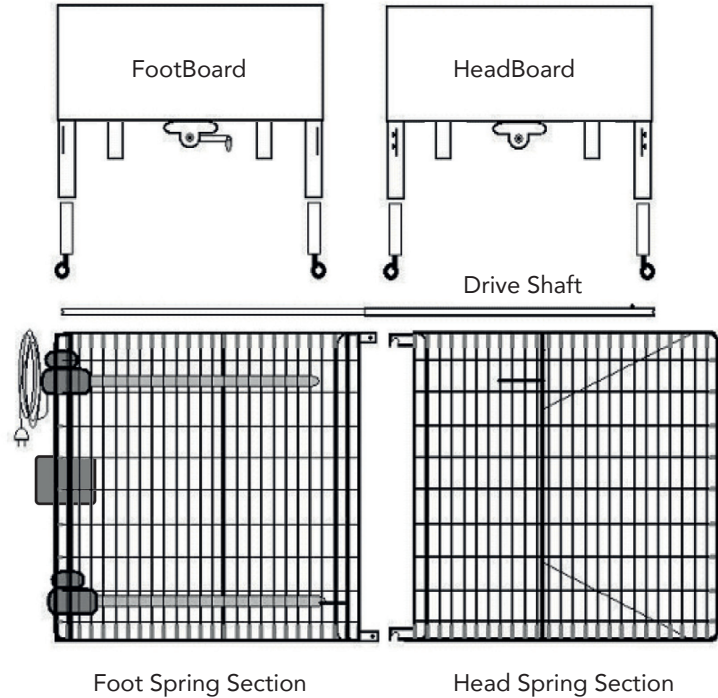

Figure 1: Example of Major Components

BED PARTS DIAGRAM

Confirm that all parts are present.

1. Foot Spring
2. Head Spring Assembly
3. Foot Board Assembly
4. Headboard Assembly
5. Casters - 2 locking, 2 non-locking
6. Drive Shaft (Two Pieces)
7. Emergency Crank Handle
(Optional Accessory)
8. Pendant with Cord
9. Junction Box
10. Motor/Actuator for Foot Spring
11. Motor/Actuator for Head Spring
12. Hi-Low Motor Assembly
13. Gear Box for Head Board
14. Gear Box for Footboard No Handle
16. Fasteners Set for Head Spring Motor
17. Extension Tube of Head Motor Assembly
18. Fasteners Set for Foot Spring Motor
19. Gear Box Screw
20. Panel for Headboard/Footboard
21. Composite Inserts for Casters
22. Emergency Battery Box

15 Not Shown

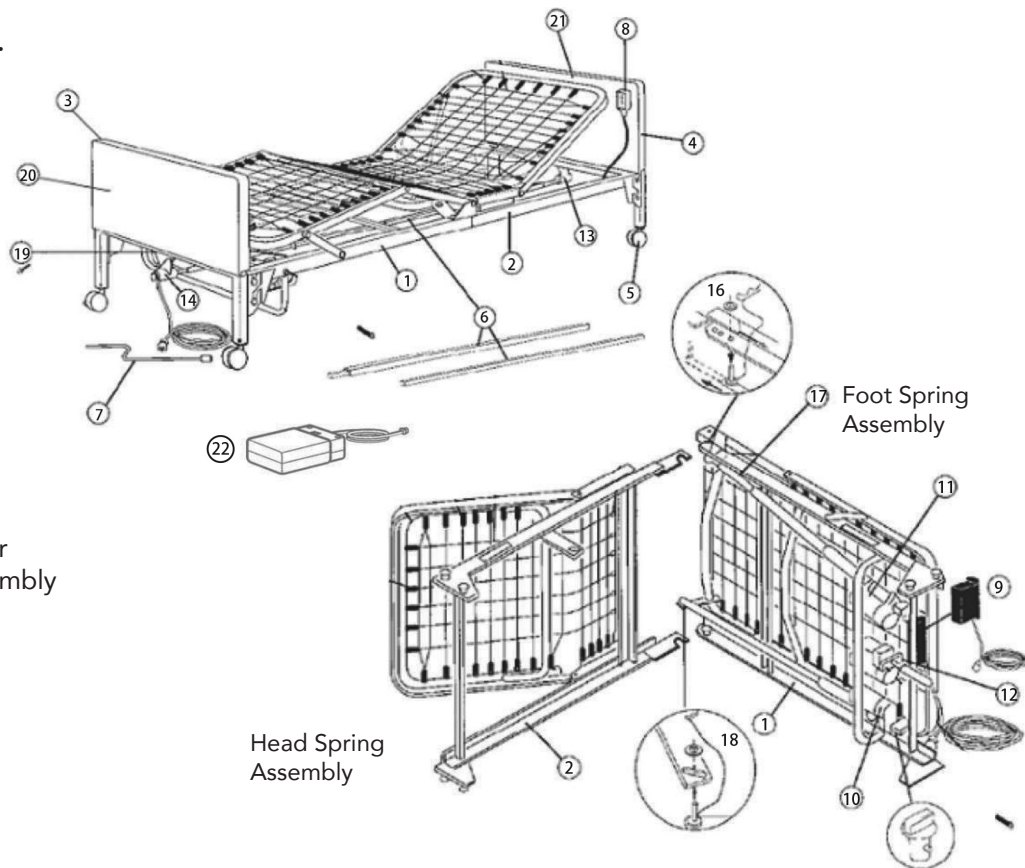

Head Spring
Assembly

Foot Spring
Assembly

ASSEMBLY INSTRUCTIONS

Before assembly, examine each item carefully for shipping damage. If a part is found to be damaged, **DO NOT** use. Contact your Dealer for instructions.

WARNING

During assembly, **DO NOT** rotate the pull tube or the shaft of the motors; all motors are adjusted to proper position prior to shipping. Rotation will lead to mis-adjustment of motors which may cause frame damage.

DO NOT attempt to operate the bed controls until assembly of the entire bed is complete as damage to bed components or personal injury may occur.

Connecting the Two Frames

Head Spring Section

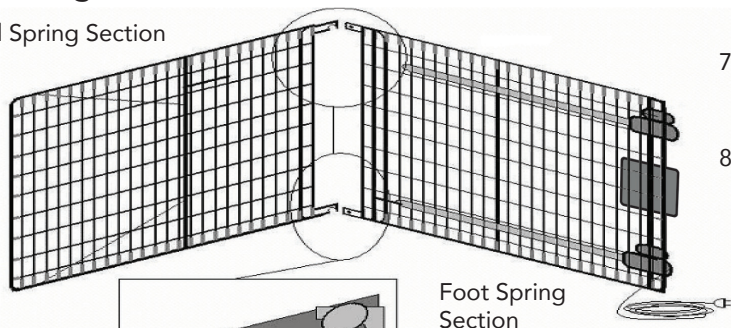

Foot Spring Section

Figure 2a

Figure 2: Connecting the Head and Foot Frames

1. Place the Head Spring Section on its side to your left with the center mounting hooks to your right.
2. Place the Foot Spring Section on its side to your right with the head frame pull tube at the top of the assembly and the center mounting rivets facing to the left.
3. The crank handles and/or motors should be at your right.
4. The head and foot springs should now be on their sides at approximately a 90° angle to one another.
5. Hook the bottom head spring center mounting latches to the bottom foot spring center mounting rivets. (see Figure 2a)
6. Hook the top head spring center mounting latches to the top foot spring center mounting rivets. (It may be necessary to lift slightly on the head spring or foot spring to secure the mounting latches and rivets.)
7. After head and foot springs are connected, slowly open the springs into a horizontal (straight) position while still on their sides. Make sure the hooks engage the rivets at all times.
8. Lay the bed flat with the springs facing up.

ASSEMBLY INSTRUCTIONS CONT.

Connecting the Spring Fabric

1. With the bed flat and the springs facing up, lift the head spring section upward to give slack to the fabric. Connect the spring fabric together with the links provided.
2. Hook together all the links to the spring fabric.
3. Lower the head spring section back down.

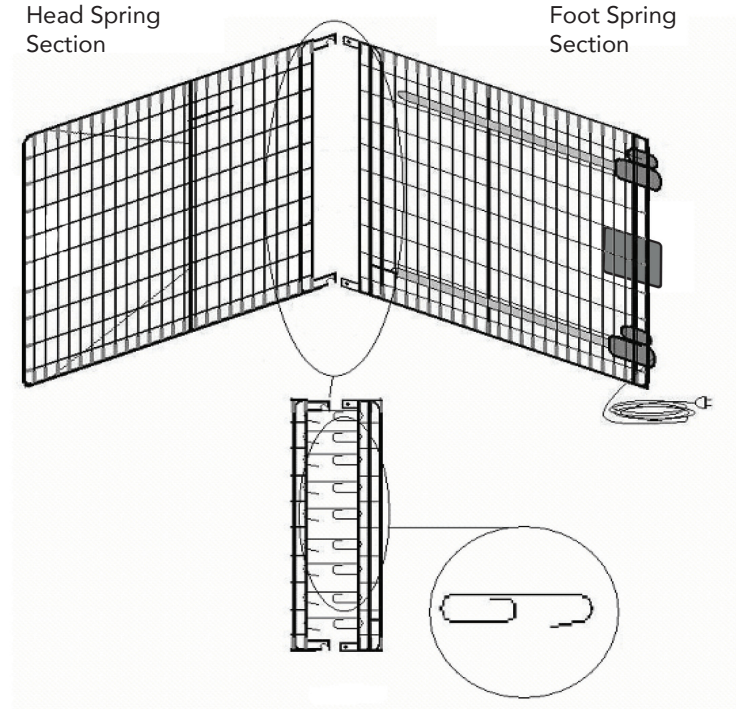

Figure 3: Connecting the Spring Fabric

ASSEMBLY INSTRUCTIONS CONT.

To Install Casters

Ensure that the locking casters are installed diagonally from each other and are locked. This will provide maximum locking stability.

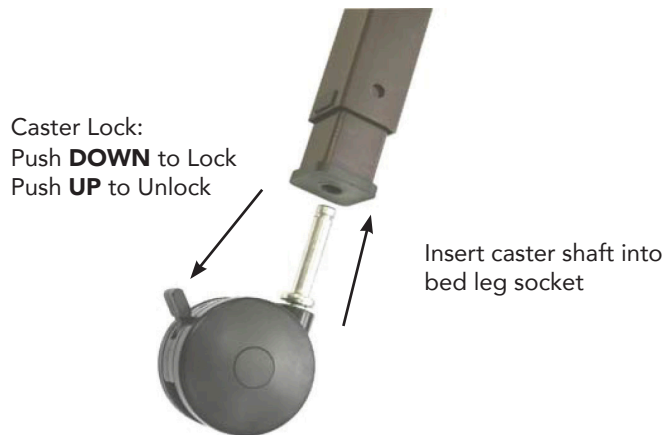

Figure 4: Casters

1. Lay the bed ends flat on the floor.
 2. Position the two locking casters so they will be diagonally opposite from one another when the bed is assembled. See Figure 4B.
 3. Insert the shaft of the caster into the caster socket of each bed leg. Ensure the stem is fully inserted into the socket. See Figure 4.
 4. To prevent excess movement of the bed during assembly, lock each of the two locking casters by pushing down on the caster lock.
- NOTE:** Locking the casters may not prevent the bed from moving on slick or slippery surfaces.
5. To unlock the two locking casters, pull up on the caster lock.

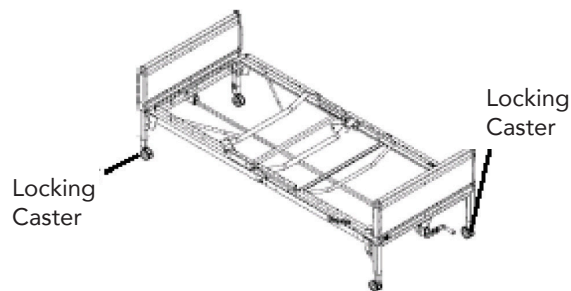

Figure 4B: Locking Caster Positioning

ASSEMBLY INSTRUCTIONS CONT.

To Install the Headboard and Footboard

⚠ CAUTION

DO NOT place your hand between the spring section and the bed ends while attaching the bed boards as injury may occur.

1. Stand the headboard as close to the head frame as possible.
2. Raise the head frame until the rivets on the corner plates of the head frame fit into the corner locks on the headboard. The headboard may need to be tilted backward slightly for the rivets to slide into the locks.
3. Return the headboard to its full upright position to lock it into place.
4. Repeat this entire procedure for the foot end section.

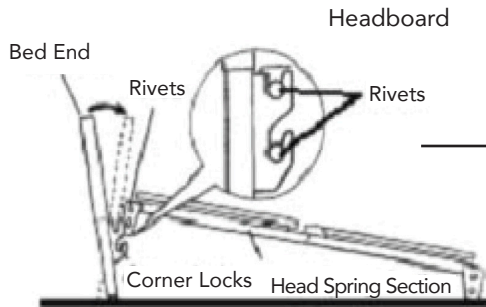
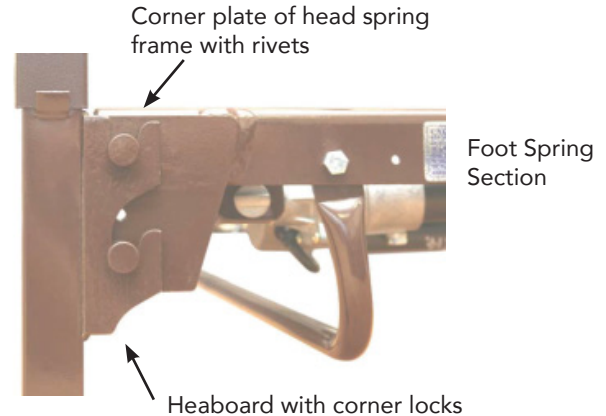

Figure 5: Headboard & Footboard Connection



ASSEMBLY INSTRUCTIONS CONT.

Patient Hand Control

Connect the patient hand control to the bed by inserting the connector into the Junction box and securing it with the Cable Securing Strap once all plugs are connected.



Patient Hand
Control
Connection

Bed Junction Box

Cable Securing
Strap

Figure 6: Bed Junction Box Connections

⚠ CAUTION

Ensure hand pendant cable is routed in a way such that it will not become entangled or pinched when the bed is adjusted.

DO NOT place the pendant hand control under or between objects. This may unintentionally press the buttons which may cause injury or damage to occur.

ASSEMBLY INSTRUCTIONS CONT.

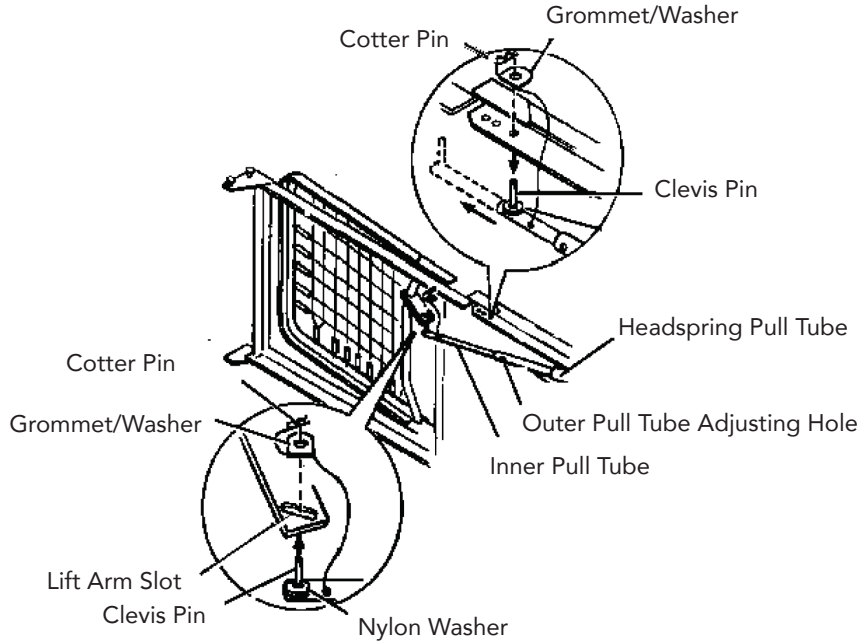

Figure 7: Head Spring Pull Tube Assembly

ASSEMBLY INSTRUCTIONS CONT.

Adjusting and Connecting the Head Spring Extension Tube



1. To provide up and down movement of the head section, attach the head extension tube to head spring motor. Make sure tube end with black plastic insert is mounted on motor shaft as shown on below



2. Pull out extension tube and slide onto frame as shown in Figure 8.
3. Connect the pull tube assembly to the lift-arm of the head spring by inserting the clevis pin into the lift-arm slot. Reconnect the grommet and washer and secure the cotter pin.

Figure 8: Extension Tube Attachment

ASSEMBLY INSTRUCTIONS CONT.

Installing the Center Drive Shaft

The drive shaft is composed of two sections that are shipped unassembled. The inner shaft, which has a positioning spring button, and the outer shaft, which has two positioning holes and one storage position hole. Together they make the telescoping center drive shaft used on all electric Hi-Lo model beds.



Figure 9: Drive Shaft

Adjusting the Center Drive Shaft

1. Depress the spring button on the inner shaft and insert the inner shaft into the outer shaft.
2. Slide the inner shaft to the correct position for the type of bed being used and engage the spring button into the proper positioning hole as follows:
 - a. For semi-electric beds: engage the spring button into the fifth hole position from the left, labeled 'SEMI'. If utilizing the extension kit, adjust the push button to the sixth hole position labeled 'SEMI EXT'.

- b. For the full electric model: engage the spring button into the first hole position from the left labeled 'FULL'. If utilizing the extension kit, adjust the spring button to the third hole position from the left labeled 'FULL EXT'.

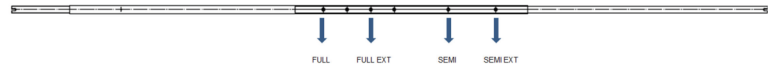

Figure 10: Drive Shaft

3. Connect the drive shaft to the bed by attaching either end of the drive shaft to the headboard gearbox. See Figure 11. For full electric beds, attach the other end of the drive shaft to the center motor by pushing the drive shaft toward the headboard gearbox to shorten the length, then fitting the other end into the extended shaft of the center motor.
4. Ensure that all components are securely installed.



Headboard Gearbox



Drive Shaft End



Center Motor

Figure 11

ASSEMBLY INSTRUCTIONS CONT.

Junction Box Connections

1. To insert cords into the junction box, line the cords up with the appropriate receptacle on the junction box and push in until fully seated.
2. Install Cable Securing Strap around wiring.
3. Snap Cable Securing Strap into place using tabs at top and bottom.
4. Check that all cables are secure.
5. Emergency Battery Box does not need to be connected when not in use.



CAUTION

DO NOT unplug the power cord from the junction box.



CAUTION

DO NOT plug in or unplug any wires unless the bed is unplugged from outlet.



Figure 12: Junction Box

Power Cord

NEVER operate the bed if it has a damaged cord or plug. If it is not working properly call a qualified electrician.

NEVER plug into an outlet that is greater than 120 Volts AC.

ASSEMBLY INSTRUCTIONS CONT.

Using the Low Bed End Option on Dual Standard/ Low Bed Ends (on selected bed models)

The low height feature of the dual standard/low bed ends have specific use requirements that are different from using the standard height position. Prior to using other accessories, **ALWAYS** verify correct placement of these products to allow for unobstructed and proper use in accordance with their respective user manuals.

⚠ CAUTION RISK OF DAMAGE

ALWAYS use the low bed setting in pairs on the homecare bed. If not used on both bed ends, the bed will not sit level, will not work properly, possibly resulting in damage to the bed and may cause personal injury. **DO NOT** combine dual standard/low bed ends with any other bed end on the same homecare bed.

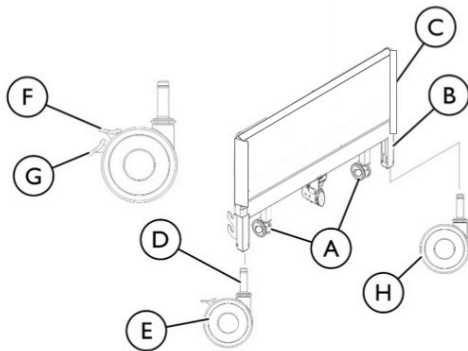

Installing the Casters onto the Low Bed Leg

On low bed leg (inside leg receptacle), casters only operate when bed is in lowest position. **ALWAYS** install locking caster in the same location on each bed end so that they will **ALWAYS** be diagonally opposite each other when bed is assembled. If two (2) locking casters are **NOT** included with the bed, contact a qualified dealer.

1. Determine desired bed height position. Install casters H in either the caster sockets A or in the bed legs B for increased bed height.
2. Install casters by first laying the bed ends C flat on the floor.
3. Insert the shaft D of caster assembly into the caster socket.
4. To prevent excess movement of the bed during assembly, lock the two (2) locking casters by pushing **DOWN** on the caster lock G. Locking the casters may **NOT** prevent the bed from moving on slick or slippery surfaces.
5. To unlock the two (2) locking casters E, pull UP on the caster lock F.
6. Refer to "Install the Headboard and Footboard", page 11 for instructions on how to install the bed ends on the bed frame.

BED OPERATION

Hand Control

Allow a slight pause between adjustments and avoid pressing multiple buttons on the pendant hand control at the same time. If buttons are depressed too rapidly or multiple buttons are pressed at the same time, the desired feature may not activate. Simply release the button, permit a slight pause and then activate the next operation.



CAUTION

NEVER operate the bed if the pendant hand control or the power cord is damaged.

Before placing the bed into use, test it by operating it through all phases of its operation.

Check for obstructions or items in the path of the head, foot or bed before operating the hand control.



Figure 13: Hand Control Functions

Plug the bed power cord into an electrical outlet. The patient hand control has four separate functions - raising and lowering the head section and raising and lowering the foot section.

To raise the head section, press the button on the left side of the pendant hand control.

To lower the head section, press the button on the right side of the pendant.

To raise the foot section, press the button on the left side of the pendant hand control.

To lower the foot section, press the button on the right side of the pendant.

Leveling the Bed

Full Electric Bed: Plug the bed power cord into an electrical outlet. Press and hold the patient hand control "Bed Hi/Lo (Up)" button until the bed reaches its highest position. Next, press and hold the "Bed Hi/lo (Down)" button until the bed reaches its lowest (and safest) position. The bed should be level. See Figure 13 for Hand controls.

BED OPERATION

Emergency Crank

Semi-electric and full electric beds can utilize an emergency crank that allows manual adjustment of the high and low function of the bed. The emergency crank can be stored in the links of the spring deck. **DO NOT** leave the emergency crank in place after power is restored and the bed pendant is being utilized.

To Use The Emergency Crank

1. Locate the exposed shaft end according to the function you want to perform.

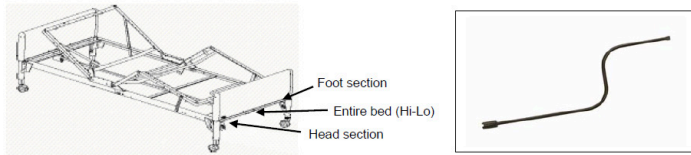

Figure 14: Emergency Crank and Shaft Positioning

2. Attach the emergency crank to the shaft end of the desired function.
3. Push in and turn the crank clockwise to raise the desired function, counterclockwise to lower the function.

Emergency Battery Box

Semi-electric and full electric beds can utilize an emergency battery box that allows manual adjustment of the head and foot spring in the event of a power failure. **DO NOT** leave the battery box connected to the junction box while not in use. Be sure to check batteries regularly.

To Use The Emergency Battery Box

1. Two 9 volt Alkaline batteries are needed to power the battery box.
2. Connect the battery box to the junction box in the port marked battery.
3. Once connected the head and foot spring can be lowered using the hand pendant.

WARNING

ALWAYS remove the manual hand-crank **BEFORE** performing electric operation. **DO NOT** operate the electric functions with the manual hand-crank installed on the bed or product damage and personal injury may occur.

Bed Transfers

When transferring in or out of the bed, **ALWAYS** ensure the locking casters are in the locked position. The bed height may be adjusted either up or down, as required, to make transfer safer and easier for the bed user.

HEAD/FOOT BOARD OPTIONAL HEIGHT ADJUSTMENT

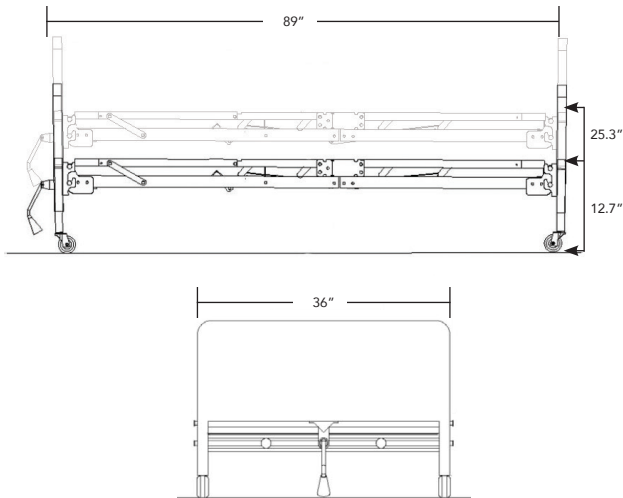

Figure 15

MAINTENANCE AND SAFETY CHECKS

Inspecting the Bed

The following maintenance procedure should be conducted annually, between placements or as required:

1. Inspect casters to ensure they roll and lock properly.
2. Inspect pull tubes and motor drive shafts to ensure they are not bent, damaged or excessively worn.
3. Inspect headspring and foot spring sections for excessive wear, bent parts, or other damage.
4. Inspect all welds for cracks.
5. Check all spring decks to ensure links are in place and are not damaged.
6. Inspect all bolts and rivets to ensure they are tight and are not damaged.
7. Inspect all other mechanical parts to ensure there is no damage or excessive wear.
8. Inspect all bed motions: headspring raises/lowers properly, foot spring raises/lowers properly, bed height raises/lowers properly.
9. Ensure all electrical cables have no insulation damage and connectors are in proper working order. Check that all cords and wires are routed, attached and fully inserted properly so they do not interfere with any moving parts.
10. Inspect the electrical junction box to ensure there are no cracks and the electrical power cord is not damaged.
11. Inspect all electrical bed components for damage or excessive wear (i.e. cracked or broken housing, worn components.)

MAINTENANCE AND SAFETY CHECKS CONT.

12. Inspect pendant, power, and motor cords for excessive wear, insulation damage, or cuts.
13. Inspect all bolts that are at hinge points. Apply a minimal amount of lithium grease if needed.
14. Check the center drive shaft to ensure it is not bent and the ends are in good condition.
15. Replace the 9V battery annually or after each use.
5. Thoroughly dry all bed parts and components.
6. Disassemble the headspring and foot spring assemblies before washing. When cleaning headspring and foot spring assemblies, stand the assemblies on edge and wash with a mild detergent. Using a soft sponge or brush, scrub all exterior surfaces. Rinse thoroughly, then completely towel dry all components.
7. To disinfect the bed, wipe down all surfaces of the bed with a disinfectant and allow to dry completely.

Cleaning the Bed

WARNING

ALWAYS unplug the full-electric bed before cleaning.

1. Homecare beds should not be washed down with a pressure washers or steam cleaner. Doing so can result in problems with the electrical system.
2. Inspect bed components for any exposed metal.
3. Electrical components (motor, junction box, and pendant which are rated as IP66), frame and head board/foot boards are washable with standard water pressure.
4. The headboard and footboard should be disconnected from the frame before cleaning. When cleaning the headboard and footboard, stand them in an upright position, and use a mild detergent and soft cloth. Gently scrub all exterior surfaces. The headboard and footboard can be rinsed thoroughly with warm water. **DO NOT** exceed a water temperature of 110 °F/43.3 °C.

SPECIFICATIONS

Electrical	Motors are ETL Approved
Weight Capacity	Distributed Total - up to 450 lbs. / Patient up to 350lbs.
Construction	Frame: 11ga (.120) hot rolled steel. Sleeping surface: Zinc plated steel wire and coils
Finish	Durable Powder Coating
Overall Bed Dimensions	89" long X 36" wide
Mattress Deck Height (with no mattress)	Minimum – 12.7" Maximum – 25.3"
Bed Frame Weight (assembled)	185.4 lbs.
Maximum angles of the mattress platform	Head: 70° Foot: 5°
Mattress Requirements	Size – 80" long X 36" wide X 6" deep Homecare bed-compatible, e.g. PBHBMATFB
Side Rails Requirements	Homecare bed compatible, half or full (e.g., PB6034 and PB7035) manufactured for direct bed frame attachment
Battery	Lowers head and foot one time, will not lift the head or foot sections (9V not included)

LIMITED WARRANTY

- Your ProBasics brand product is warranted as follows:
 - Frame – 5 years
 - Motor – 2 years
 - All other parts - 1 year
- This device was built to exacting standards and carefully inspected prior to shipment. This Limited Warranty is an expression of our confidence in the materials and workmanship of our products and our assurance to the end user of years of dependable service.
- This warranty does not cover device failure due to misuse or negligence, or normal wear and tear. The warranty does not extend to non-durable components, such as rubber accessories, casters, and grips, which are subject to normal wear and need periodic replacement.
- If you have questions about your ProBasics device or this warranty, please contact an authorized ProBasics dealer or Compass Health Brands.



6753 Engle Road
Middleburg Heights, Ohio 44130
Tel.: (800) 376-7263
www.compasshealthbrands.com
42-PBFEB3M_01 ©2020
Made in China